

STAINLESS STEEL PALLET TRUCK

5,500 LB CAPACITY

**2.9" LOWERED
HEIGHT**

**REINFORCED
FORKS**

FEATURES & BENEFITS

- Safety designed loop handle, includes neutral position, and fingertip release
- Spring-a-matic handle self returns to vertical position
- 215° pivot action maneuvers in compact area
- One piece formed steel "C" channel tapered, reinforced forks
- Leak-proof pump assures maintenance-free
- Stainless Steel ram & piston
- Urethane seals and wipers
- Large steer wheels with "ball-thrust" steering
- Sealed ball bearings throughout
- All pivot points can be lubricated easily
- Tapered fork ends and nylon rollers permit easy entry and exit of pallets
- Nylon steer wheels and load rollers
- Only 1 capscrew and 4 pins to remove hydraulic unit

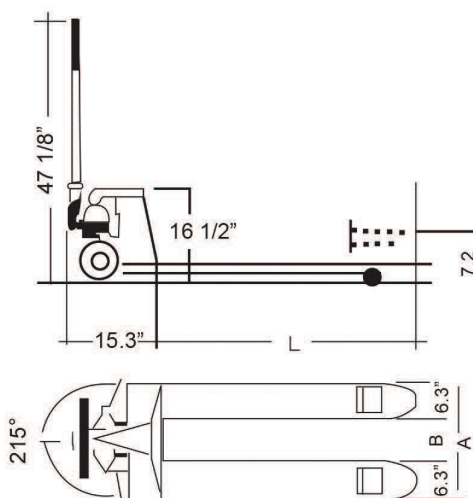

**LEAK-PROOF
HYDRAULIC PUMP**



**ERGONOMIC RUBBER
GRIP HANDLE**



**NON-MARKING
WHEELS**

SPECIFICATIONS

Load Capacity	5,500 lbs.
Lowered Height of Forks	2.9"
Raised Height	7.2"
Overall Width Across Forks (A)	27"
Fork Width	6.3"
Space Between Forks (B)	14.4"
Standard Fork Length (L)	48"
Load Wheels (Nylon)	2.9" x 3.7"
Steer Wheels	7" x 2"
Body Length (Including Pump)	15.3"
Load Roller Axle to End of Truck:	
- Roller Down	7.83"
- Roller Up	9.84"
Approximate Weight	200 lbs.

ABOUT THE UNIT

3 POSITION HAND LOWERING CONTROL HANDLE

Lifting - Neutral - Lowering foot pedal is an added feature neutral allows free handle movement when the truck is in motion. The handle returns automatically to the vertical position.

HIGH QUALITY HYDRAULIC UNIT

The hydraulic system is the result of years of research and development, including a load limiter which prevents premature wear from overloading. A Specially designed lowering valve permits gentle lowering of heavy loads. The hydraulic unit is sealed to prevent moisture from entering the unit.

WARRANTY

Atlas warrants this equipment when used under normal operating conditions excluding acid and alkali environments, to be of proper materials and first class workmanship. We agree to exchange, excluding labor, any defective moving parts (bearings and wheels, and hydraulic parts not including the chassis) returned to us by prepaid freight within 12 months from date of shipment.